

# ENGINEERING SPECIFICATIONS FOR 21" ATMOSPHERIC GAS FIRED INFRA RED BURNER

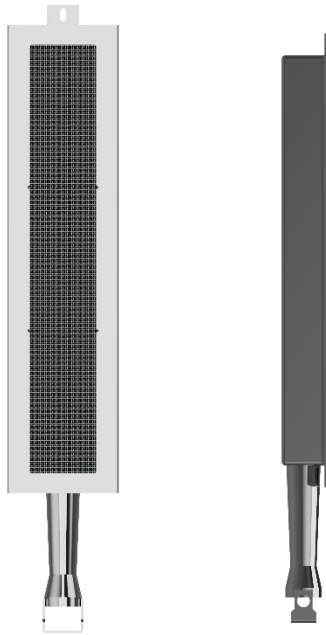

SERIES	INPUT	RADIANT SURFACE AREA	NET WEIGHT
BI21A-N	XX,XXX – XX,XXX BTU/h	31.25 Sq. In.	Unique Per Configuration

#### Normal Manifold Pressure

- Natural Gas- 3.5 - 6" W.C.

#### Minimum Inlet Pressure

- Natural Gas- 5" W.C.

#### Available Emitter Surfaces

- Wire Mesh

#### Options

- Gas Orifice
- Gas Orifice Locator Bracket
- Brass Fittings
- Factory Pre-Burn
- Mounting Tabs

**NOTE:** Values and inputs may be subject to change per application or orientation.



#### PROCESSBURNERS.COM

21400 Hoover Road • Warren, Michigan 48089

Phone: 586-756-0950 • Fax: 586-756-2626

sales@drp-co.com • www.processburners.com

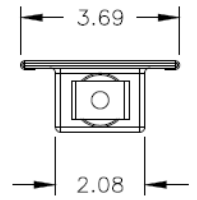
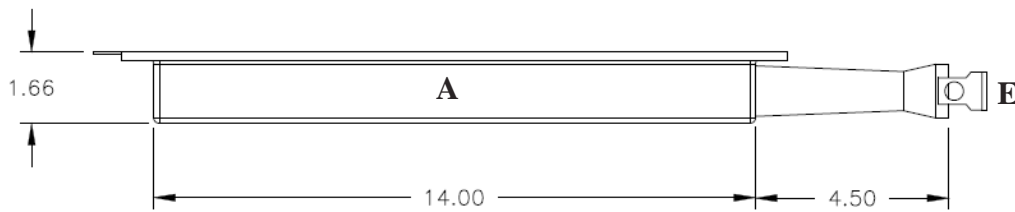
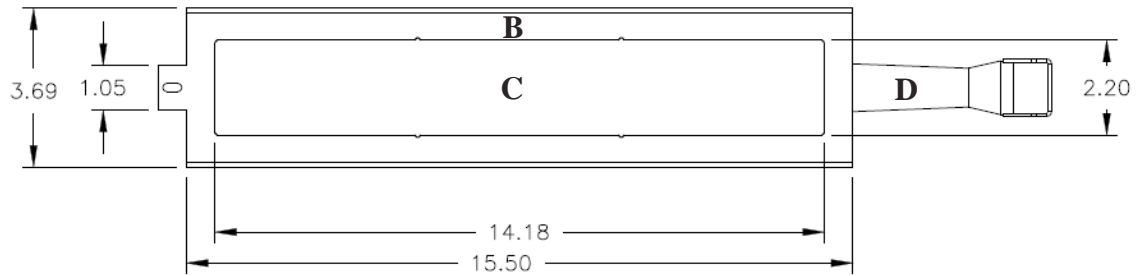

### DESCRIPTION

- A. Plenum Chamber
- B. Hold Down (304 Stainless Steel)
- C. Emitter Surface (Additional Options Available)
- D. Venturi
- E. Gas Orifice Locating Bracket

**NOTE:** Burner length is subject to change to meet customer demand but will not exceed 30" long.